

MASSE IN "mm"
DIMENSIONS EN "mm"

ÄNDERUNGEN, SATZ- UND DRUCKFEHLER VORBEHALTEN
SOUS RESERVE DE MODIFICATIONS ET D'ERREURS TYPOGRAPHIQUES OU D'IMPRESSIONS

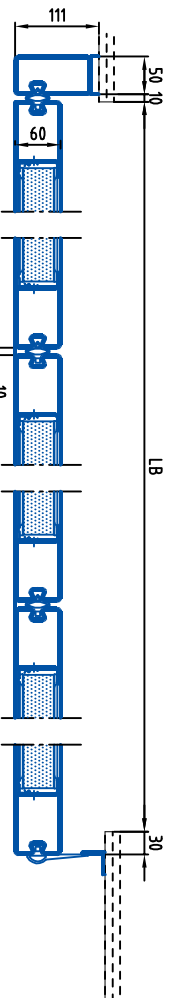

Torhöhe nach Auswahltabelle
Elementbreite max. 1500mm
Hauteur de porte selon diagramme
Largeur par élément max. 1500 mm

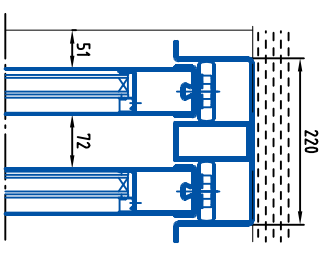
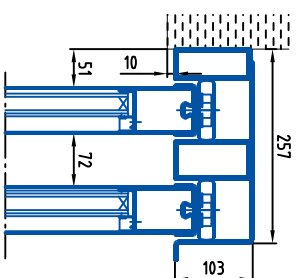
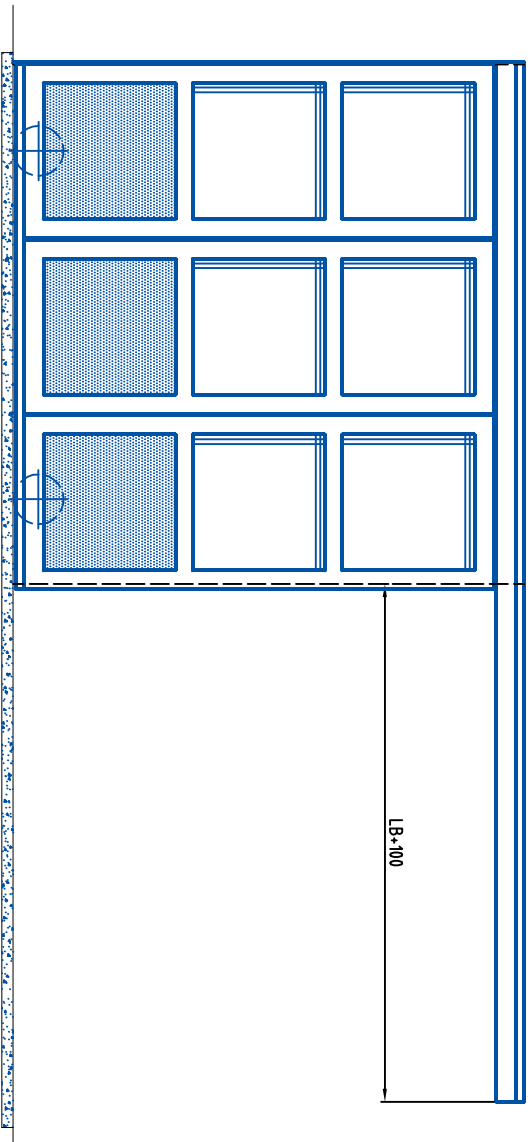
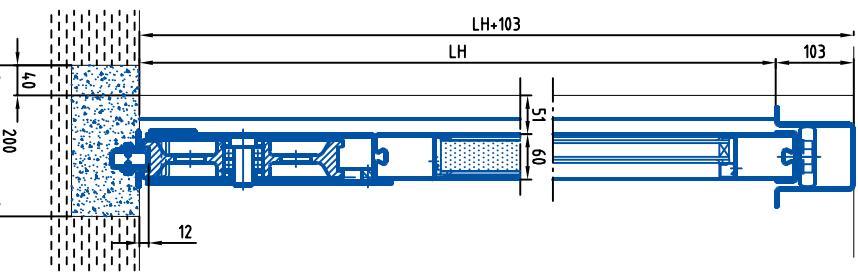
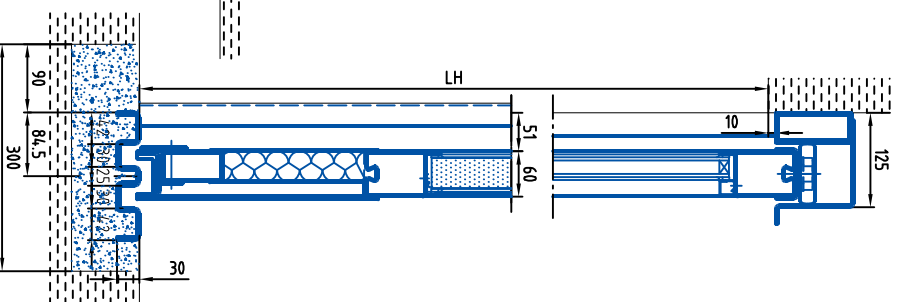
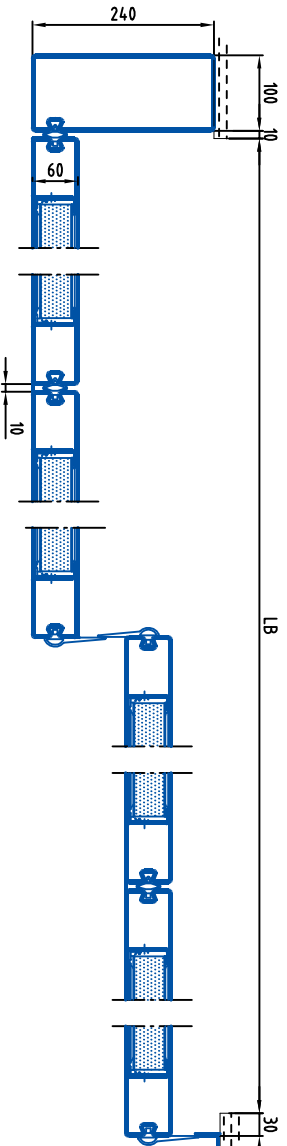

Stahl Schiebetor Hand Typ: 60E LWU
Porte coulissante manuelle roulante en bas

Datum:
Date:
Zeichn.Nr.:
Plan N: 30-100122

Bator
T O R S Y S T E M E
CH-3360 Herzogenbuchsee
Telefon 062 956 12 12
Telefax 062 956 12 13
http://www.bator.ch
E-Mail bator@bator.ch